

1. Manufacturer

Tost GmbH Flugzeuggerätebau München
Thalkirchner Straße 62
80337 München • Deutschland

2. Type/Product

Landing wheel Mini 150 V

3. P/N

0 3 1 5 1 3 wheel hub
0 3 1 5 0 1 wheel hub fitted with tire

4. Characteristics

Two-part wheel hub from aluminum
CNC-manufactured from solid
Threefold screwed
Maintenance free, sealed ball bearings
For axle diameter 12 mm
Spacer between bearings for axial bracing on axles or stub shafts
Surface anodized in blue (other colours on request)

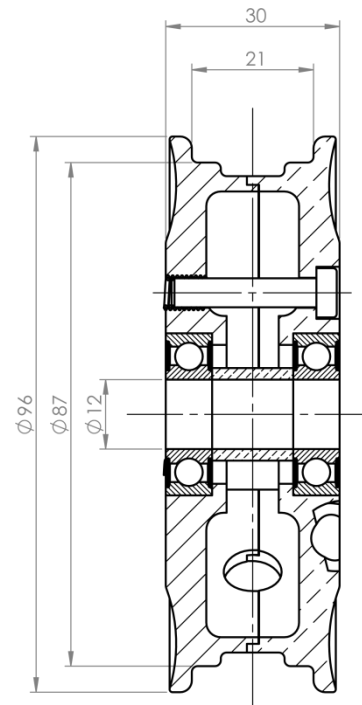

5. Dimensions / Weight

Installation width: 30 mm
Bearing diameter: 12 mm
Weight
w/o tire: 300 g / 0,66 lbs
with tire and tube: 490 g / 1,1 lbs

6. Application

Landing wheel for aircraft, tail wheel, support wheel

7. Operating Limits

Static load: 80 kg at 100 km/h
Max. static load: 1,0 kN / 224 lbs
Max. limit load: 2,8 kN / 630 lbs
This loads refer to the operating limits of the tire.

Tost GmbH Flugzeuggerätebau Thalkirchner Straße 62 • 80337 München • ☎ +49 89-544 599-0 • Fax +49 89-544 599-70 EASA Production Organisation DE.21G.0065 • EASA Maintenance Organisation DE.145.0411 Design Organisation EASA.AP230 • www.tost.de • info@tost.de	Specification	Date:	Name:
	prepared:	09.08.2017	Ehrat
	checked:	10.08.2017	Maschkowitz

8. Marking

P/N, manufacturer, S/N, wheel size and specification engraved in the wheel hub

9. Tire

Tire 150 x 30 (6 x 1¼) 6PR, P/N 062151

Tube 150 x 30 (6 x 1¼) with angle valve 30°45°25G, P/N 062153

Only Tube Type tires approved

Load limits of the tire must be observed.

Filling pressure has to be applied in accordance with aircraft manufacturer manuals and the tire deflection curve.

10. Tire installation

Unfold tube by inflating it slightly, place it in the tire

Put wheel half (valve hole side) on the tire/tube, stick valve through the valve hole, screw on the valve extension (with shortened thread P/N 069981) for temporary fixation

Place spacer in the wheel half (thread side) with centering axle (Ø 12 mm)

Place tire with up-pointing valve on the wheel half (thread side)

Match bolt holes with centering shaft (5 mm)

Tighten all three bolts with a calibrated torque wrench to the correct torque of 400 N/cm (3 ft-lbs)

Tost GmbH Flugzeuggerätebau Thalkirchner Straße 62 • 80337 München • ☎ +49 89-544 599-0 • Fax +49 89-544 599-70 EASA Production Organisation DE.21G.0065 • EASA Maintenance Organisation DE.145.0411 Design Organisation EASA.AP230 • www.tost.de • info@tost.de	Specification	Date:	Name:
	prepared:	09.08.2017	Ehrat
	checked:	10.08.2017	Maschkowitz